

MEETING & EVENT GUIDE

THE LODGE AT BRAINERD LAKES

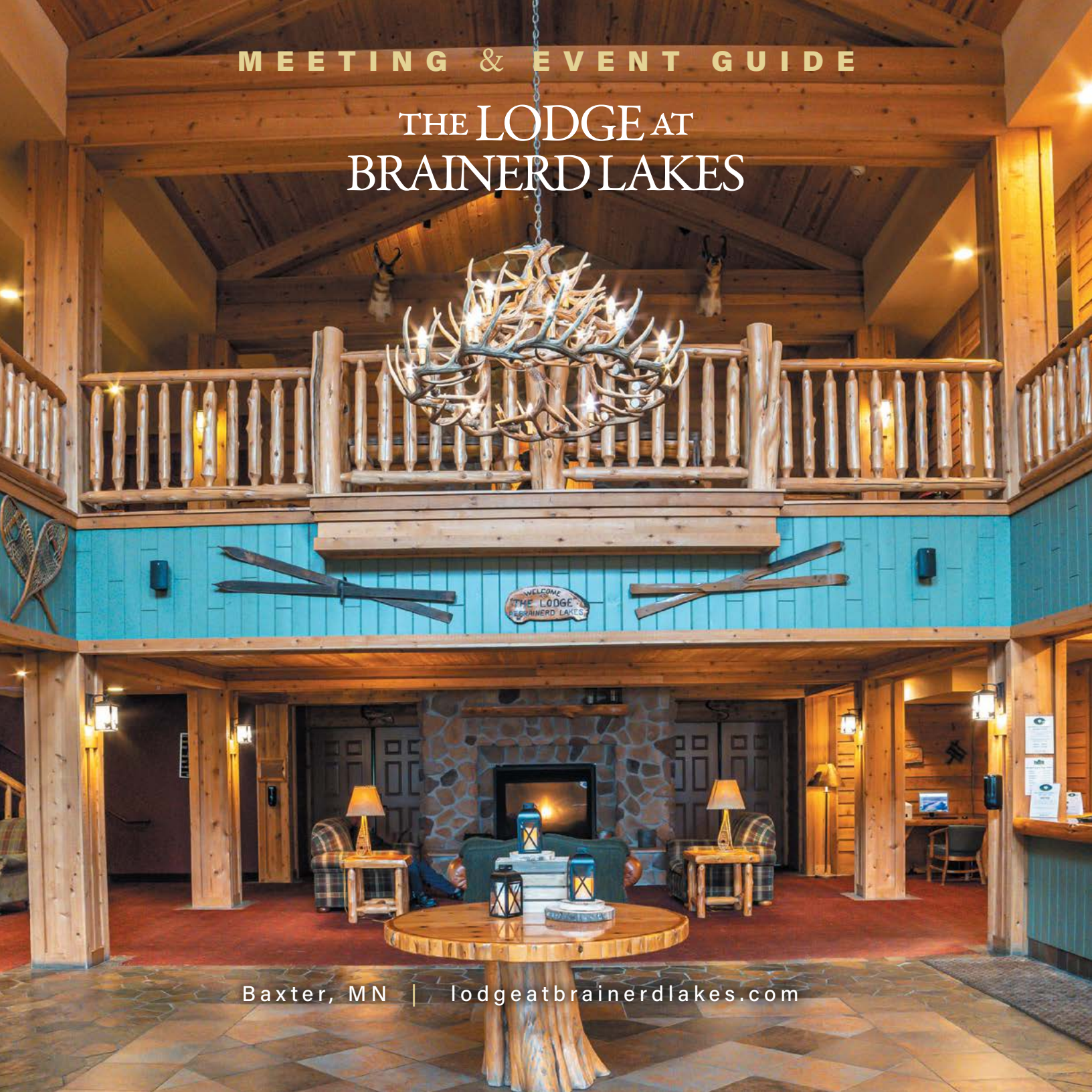

Baxter, MN | lodgearatbrainerdlakes.com

WELCOME

The Lodge at Brainerd Lakes offers a natural, rustic style with the cozy warmth of natural wood, stone fireplaces and sweeping views.

AMENITIES

- 102 luxuriously appointed guestrooms and suites (our standard guestrooms are 100+ square feet larger than the average hotel guest room; that's why we call them cabins!)
- 6 multiroom themed suites
- 8 ADA approved accessible rooms
- Complimentary hot breakfast buffet with every stay
- Complimentary Wi-Fi throughout the property
- 7,500 square feet of flexible meeting/banquet space
- Baxter's Bar & Grill – on-site restaurant and lounge
- Room service available
- 30,000-square-foot indoor waterpark and arcade
- Indoor/outdoor hot tub
- Fitness center with gym-quality equipment
- Firepit for after-function gatherings
- Outdoor recreation includes a sand volleyball court, zip line, and children's playground
- Oversized parking lot to accommodate trailers





YEAR-ROUND FUN

The Brainerd Lakes area of north central Minnesota is one of the top vacation destinations in the upper Midwest. Brainerd and the surrounding area offer a multitude of sports, recreation and entertainment for everyone. Fishing is popular throughout the year, while winter attracts ice fishermen, snowmobilers and downhill and cross-country skiers. The warmer months attract those interested in activities such as boating, water skiing, golf and bicycling. Just minutes away from The Lodge at Brainerd Lakes is the Brainerd International Speedway and the North Central Speedway for racing fans—plus shopping, spas, and more for your recreational enjoyment!



ACCOMMODATIONS

The Lodge at Brainerd Lakes has 102 spacious, cabin-inspired rooms and premiere suites. You'll find modern amenities, such as a mini-fridge, microwave, coffee maker, and free Wi-Fi, in every room.

STANDARD ROOMS

Choose from our king or double queen rooms with separate living room area and sofa sleeper.

PREMIER SUITES

Ideal for larger families or groups of up to eight. (Adjoining rooms available.)

KITCHEN SUITE

2 bedroom, 1 bath suite featuring a full-sized kitchen and living room area. The first bedroom features a whirlpool for two and king bed, and the second has 2 queen beds.



Kitchen Suite

CINEMA SUITE

3 room, 1 bath suite. First bedroom area features 2 queen beds. Walk through to the theater room with a pullout sectional couch, surround sound and big screen TV, complete with Play Station, X-Box and wet bar with mini refrigerator, microwave and coffeemaker. The second bedroom features a whirlpool for two and king bed.

KIDS' SUITE

2 bedroom, 1 bath suite with king bed, whirlpool for two and separate room specially decorated for kids, complete with queen bunk beds and climbing wall. Living room area has a large table and wet bar with full sink.

KING WHIRLPOOL

Escape to a romantic suite featuring a king bed, gas fireplace and whirlpool for two.

LOFT SUITE

First bedroom area features a queen bed. Walk past the bathroom and wet bar to the living area with gas fireplace and patio area. Up the steps, you'll discover two additional queen beds.



GUEST ROOM AMENITIES

- Luxurious linens on pillow top mattresses
- Multiple smart TVs in each guest room
- Spa-quality bath products
- Coffeemaker, mini refrigerator and microwave
- Hair dryer, iron and ironing board
- Large executive work desk
- Many rooms with pullout sofa beds to accommodate additional guests

EVENT SPACES

*Experience Minnesota hospitality
at its best.*



Red Sands Ballroom

The Lodge at Brainerd Lakes is more than a place to get away from it all – it is a premier meeting, conference, and event facility. With over 7,000 square feet of flexible meeting and banquet space, it is one of the largest and newest facilities in the Brainerd Lakes area. The Lodge at Brainerd Lakes can accommodate meetings from 10 to 400+ attendees and everything in between. In addition to our state-of-the-art meeting space, we offer an award winning culinary staff that will provide a breathtaking display of food.

HEADWATERS BOARDROOM

Above the lobby on the second floor, the Headwaters Boardroom is ideal for conducting small business meetings, training sessions, conference calls or interviews, with comfortable seating for up to 14.

BAIT & TACKLE / OJIBWA MEETING ROOMS

Also located on the second floor, the Bait & Tackle and Ojibwa meeting rooms are ideal for intimate executive retreats, planning sessions or small meetings. These rooms can also serve as breakout rooms for larger events.

RED & WHITE SANDS BALLROOMS

The Sands Ballrooms are located on the main floor, adjacent to the lobby with walkout patio access, and can be divided into the Red Sands and White Sands rooms. The White Sands room is a two-story great hall space featuring a two-story, fieldstone gas fireplace. The Red Sands room also features a fieldstone gas fireplace



Bait & Tackle

and access to an outdoor fire pit. The versatility of the Sand Ballrooms makes them ideal for both social and business events, from wedding receptions and family reunions to seminars and trade shows.

The possibilities are endless.



Sands Ballroom



Ojibwa

MEETING ROOM AMENITIES

- 5,200-square-foot ballroom dividable into 2 breakout rooms
- One executive boardroom furnished in the deep, rich colors of the northwoods
- 2 meeting rooms, perfect for small to medium-sized breakout and training sessions
- Private group registration available
- Outdoor patio for additional banquet space
- Oversized ballroom doorways perfect for accommodating large freight
- Wi-Fi access in all meeting rooms and pre-function space
- In-house audiovisual equipment available

EVENT SPACES

MAIN LEVEL

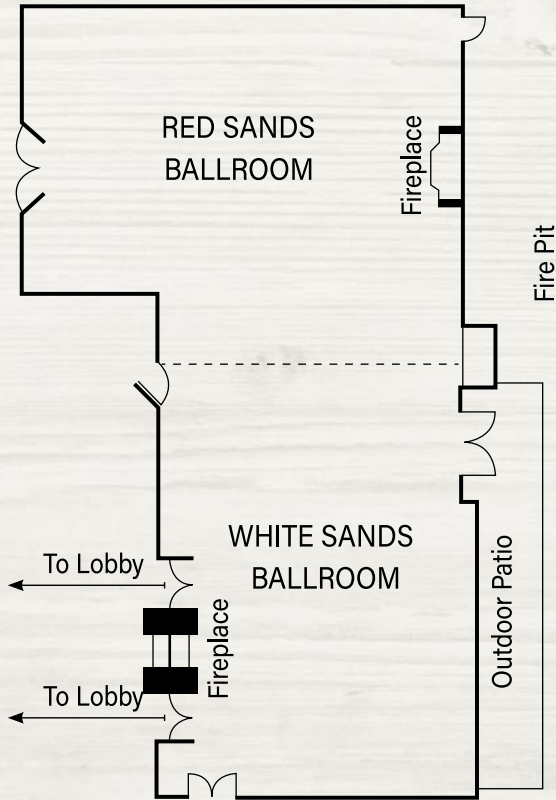

SECOND FLOOR

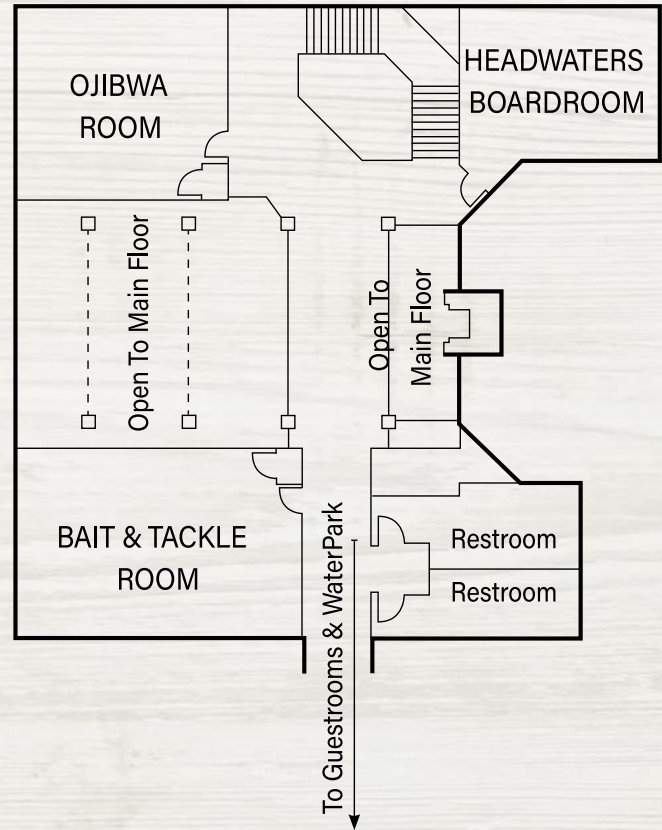

ROOM CAPACITIES & DIMENSIONS

ROOM	Ceiling Height	Room Dimensions	Sq. Ft.	Reception	Banquet	Classroom	Theater	Half Rounds	U-Shape	Hollow Square	Display Tables	8 x10 Booths	10 x10 Booths
Headwaters Boardroom	8.4	24x19	456	n/a	n/a	n/a	n/a	n/a	n/a	n/a	n/a	n/a	n/a
Trapper's Lounge	8	24x23	552	50	n/a	n/a	n/a	n/a	n/a	n/a	n/a	n/a	n/a
Ojibwa	8.4	25x23	575	50	40	20	40	25	24	28	16	4	4
Bait & Tackle	8.4	33x23	759	70	64	30	60	40	33	38	22	6	6
Sands Ballroom	9-16.10	104x50	5,200	300	300	200	420	180	105	120	90	32	22
Red Sands	9	50x46	2,300	200	140	72	200	115	44	75	50	14	11
White Sands	16.10	40x58	2,320	200	140	90	200	115	48	80	40	18	12
WATERPARK ROOMS													
Paul's Cabin	12	36x20	720	40	40	18	40	15	15	15	12	2	2
Babe's Barn	12	25x18	450	40	40	25	40	25	20	25	12	2	2

Ceiling Height & Room Dimensions are in feet.

** NOTE: The above capacities are strictly seating and tables only.
There are no provisions made for head table, staging, A/V equipment or any other additions.*

AMENITIES



You'll never run out of fun activities to try when you stay at The Lodge at Brainerd Lakes.

PAUL BUNYAN WATERPARK

Minnesota's premier 30,000-square-foot indoor waterpark features a nonslip rubberized deck and has plenty of slides available for your lil' lumberjack. Additional features include:

- Tube slide
- Body slide: Be ready for an exhilarating ride as you rocket outside the building and back to land in the pool four stories below!
- Zero-depth entry pool
- Life vests available
- Babe's Snack Bar
- Paul's Log Walk
- Lazy river
- Basketball hoops
- Indoor/outdoor hot tub with heated outdoor patio floor
- Paul's Cabin and Babe's Barn private party rooms
- Lifeguards on duty at all times to assure your safety
- Towels provided at the waterpark front desk
- Locker room with showers and lockers
- No outside food or beverage allowed
- Please note that children under the age of 15 cannot be left unsupervised in the waterpark.



DINING

Whether enjoying a steak in our dining room, a glass of wine in the casual atmosphere of our bar, or an entrée in the comfort of your guest room, Baxter's Bar & Grill provides an unforgettable experience that is sure to keep you coming back again and again.

Baxter's Bar & Grill proudly serves daily lunch and dinner specials, fresh pasta dishes, salads, hand-tossed pizzas with our own twist, sandwiches and tasty desserts. We have incorporated fresh and locally grown foods.



GOLD MINE ARCADE

2,400 square feet of games, prizes and fun for all ages, including pool, air hockey, racing and hunting arcade games, skee ball and more! Earn tickets with each game and redeem them for prizes!

FITNESS ROOM

Open 24/7 with all of the newest in fitness equipment.





2nd Floor Lobby



Main Floor Lobby Seating



Main Floor Lobby Seating



THE LODGE AT
BRAINERD LAKES



SECOND FLOOR

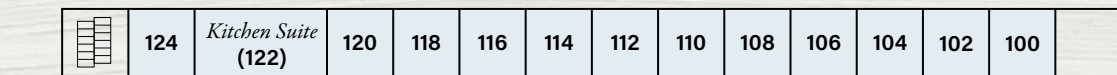
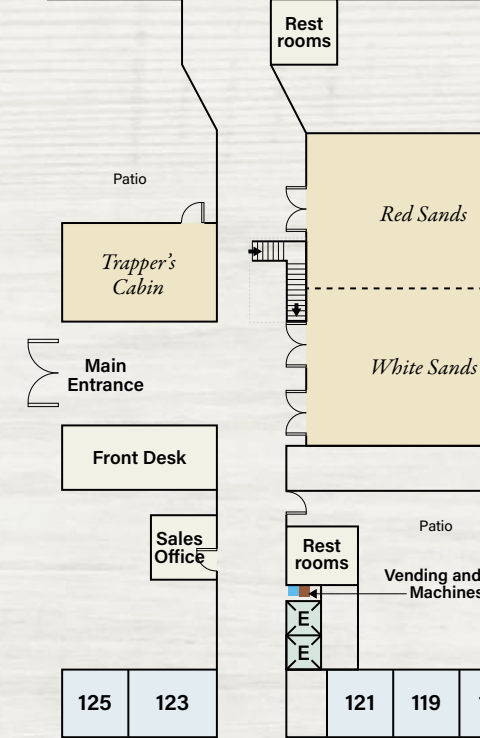
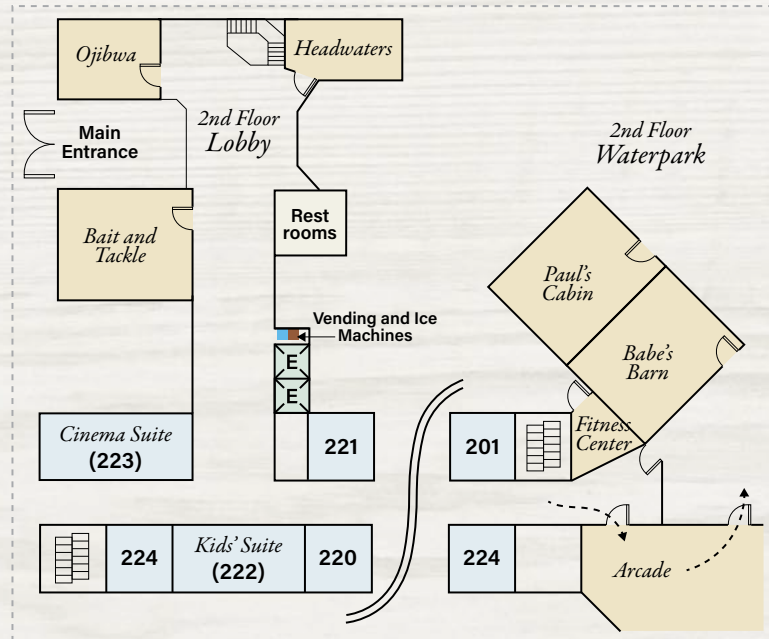



THE LODGE AT BRainerd LAKES

A cozy cabin-inspired retreat with all the comforts of a modern hotel.

6967 Lake Forest Rd | Baxter, MN 56425

218.822.5634

LodgeatBrainerdLakes.com



Wedding Wire



The Knot



Facebook